



The MB-79N is a state-of-the-art and economical addition to the Aluprof window & door systems. It has been designed to outperform typical thermal insulation requirements. The MB-79N series can be used to fabricate fixed, side-hung, hopper, tilt-and-turn, and hopper-and-slide windows, as well as single and double exterior doors, and storefront solutions complete with doors. In addition to the economical version MB-79N E, featuring a one-component central seal, and the MB-79N ST version with a two-component central seal, Aluprof also offers the MB-79N SI variant with enhanced thermal insulation, and with profiles that come equipped with insulating inserts and a two-component central seal. For external doors, Aluprof also offers the MB-79N SI+ variant that comes with a central seal and insulating inserts inside the profiles.

## INNOVATIVE SYSTEM WITH THERMAL BREAK



### Features and aesthetics

- profile depth: 79 mm (casement) and 70 mm (window frame and door leaf)
- thermal breaks made of an innovative material with a brand-new shape allow the use of a seal in the area of profile insulation, in both windows and doors
- windows in 3 thermal variants (MB-79N E, MB-79N ST, MB-79N SI'') and doors in 4 thermal variants (MB-79N E, MB-79N ST, MB-79N SI and MB-79N SI+)
- a structure meeting the Technical Requirements taking effect from 2021 for windows and doors at 0.9 W/(m<sup>2</sup>K) and 1.3 W/(m<sup>2</sup>K), respectively
- thermal insulation: U<sub>w</sub> starting from 0.64 W/(m<sup>2</sup>K), U<sub>f</sub> starting from 0.83 W/(m<sup>2</sup>K)
- excellent kinematics enabling the fabrication of narrow, operable windows and doors
- door leaf profiles have isolation joint, which eliminates thermal stresses during operation
- possibility of using invisible hinges and the most popular multi-point hardware, including hidden fittings + state-of-the-art AluPilot fittings; for doors, fittings with automation and access control functions are also available
- able to receive double or triple glazing, up to 63 mm for windows and 54 mm for doors, thus making it possible to use all common types of glass, including acoustic or burglar-resistant glass
- possibility to produce security doors rated RC1 - RC3, and panel doors in many highly aesthetically pleasing versions
- large selection & different styles of handles, including minimalist looking handles with or without rosette

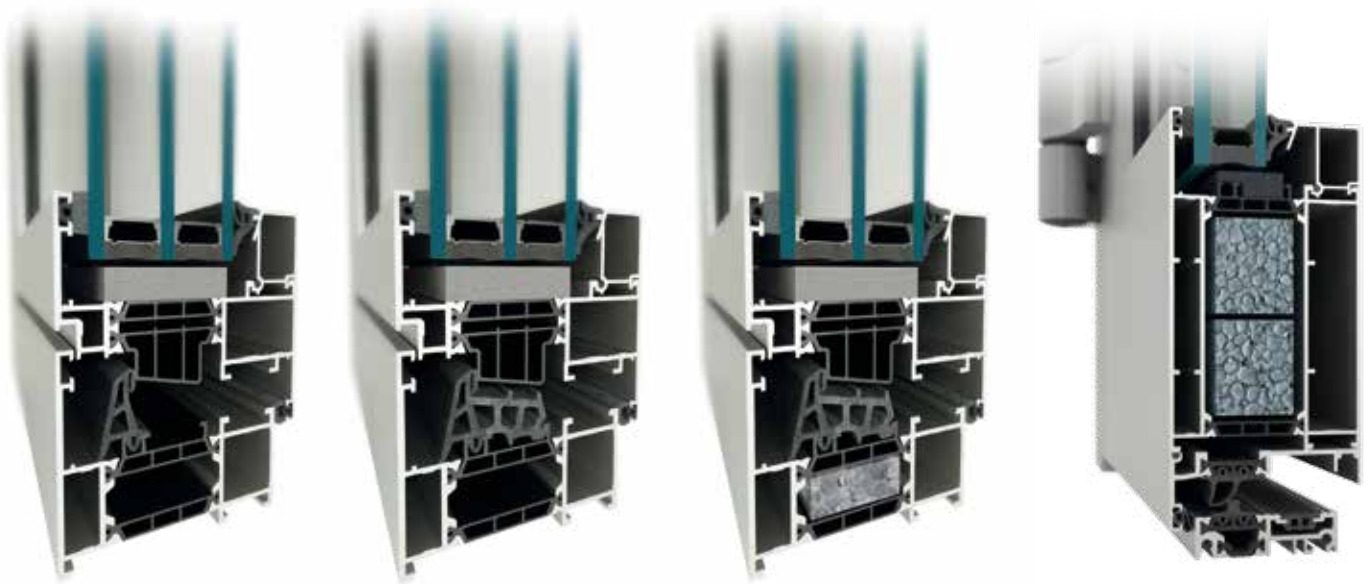

MB-79N E

MB-79N ST

MB-79N SI

MB-79N SI+ door

TECHNICAL SPECIFICATION	MB-79N WINDOW	MB-79N DOOR
Depth of frame	70 mm	70 mm
Depth of leaf	79 mm	79 mm
Glazing range	frame: 1,5 – 54 mm, leaf: 10,5 – 63 mm	leaf: 1,5 – 54 mm
Max dimensions of leaf (HxL)	H to 2700 mm, L to 1350 mm / H to 2150 mm, L to 1700 mm	H to 2800 mm, L to 1400 mm

PERFORMANCE	MB-79N WINDOW	MB-79N DOOR
Air Permeability	class 4, EN 12207	class 3, EN 12207
Watertightness	class E 1950, EN 12208	class 5A (200 Pa), EN 12208
Thermal insulation	$U_w$ from 0,64 W/(m <sup>2</sup> K)*, $U_w$ from 0,73 W/(m <sup>2</sup> K)**, $U_f$ from 0,83 W/(m <sup>2</sup> K) for MB-79N SI, $U_f$ from 1,21 W/(m <sup>2</sup> K) for MB-79N E and MB-79 ST	$U_f$ from 2,16 W/(m <sup>2</sup> K) for MB-79N ST; from 1,76 W/(m <sup>2</sup> K) for MB-79N SI; from 1,22 W/(m <sup>2</sup> K) for MB-79N SI+
Windload resistance	class C5, EN 12210	class C1/B1, EN 12210

\* -  $U_w$  for MB-79N SI fixed window, 1300 × 2700 mm, glazing  $U_g=0,5$  W/(m<sup>2</sup>K)

\*\* -  $U_w$  for MB-79N SI openable window, 1300 × 2700 mm, glazing  $U_g=0,5$  W/(m<sup>2</sup>K)

Max dimensions of window

Fixed window

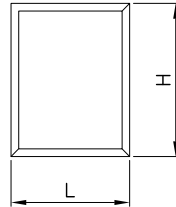

Max. dimensions of windows result from maximal glass sizes

Turn-hung window

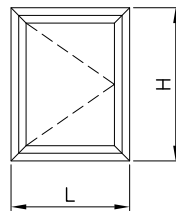

Hmax=2700 mm  
Lmax=1350 mm

Tilt and turn window

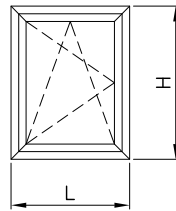

Hmax=2700 mm Lmax=1350 mm	Hmax=2150 mm Lmax=1700 mm
------------------------------	------------------------------

Tilt window

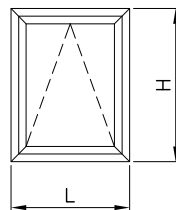

Hmax=2700 mm Lmax=1350 mm	Hmax=1300 mm Lmax=2400 mm
------------------------------	------------------------------

 } Maximal vent weight

Maximum standard door size

Inward opening door

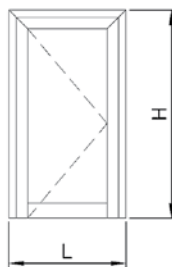

Hmax=2800 mm  
Lmax=1400 mm

 - 200 kg

Outward opening door

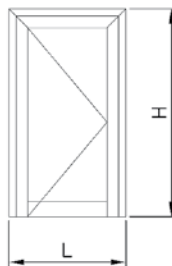

Hmax=2800 mm  
Lmax=1400 mm

 - 200 kg

 } Maximum leaf weight

Openable window MB-79N E - cross-section

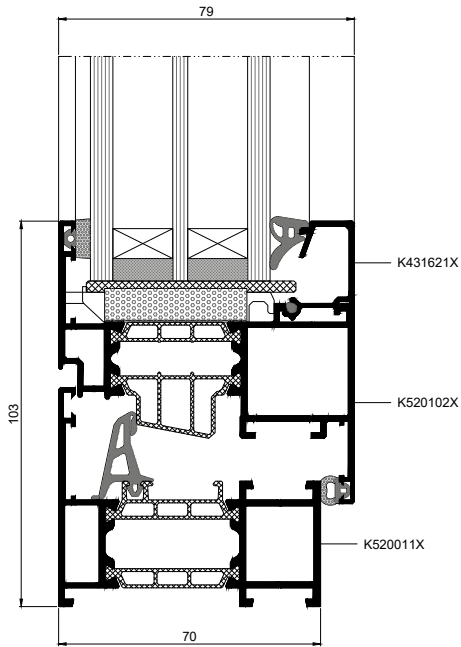

Active window MB-79N ST - cross-section

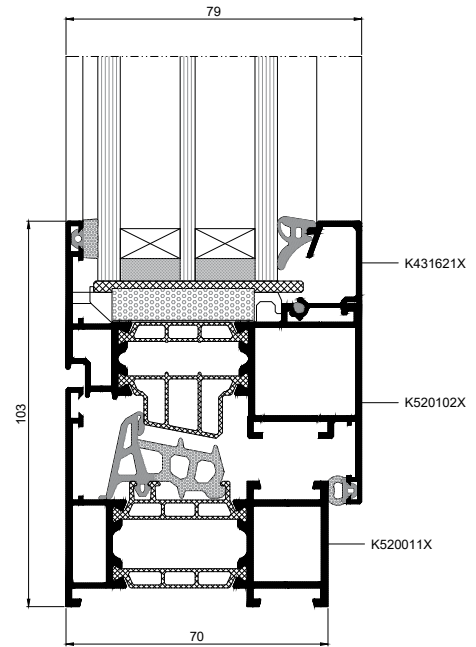

Openable window MB-79N SI - cross-section

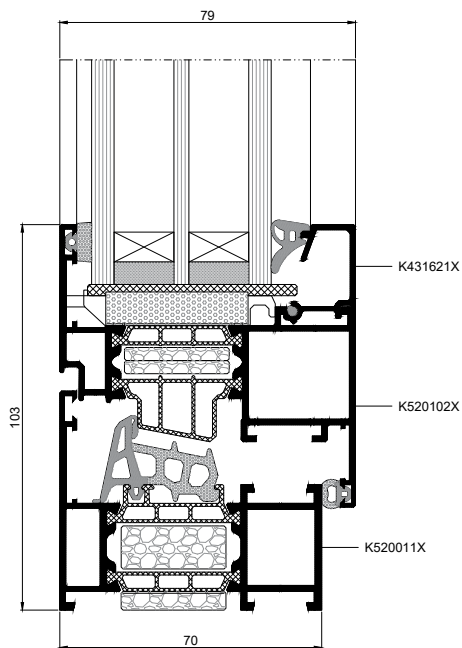

Fixed window MB-79N SI - cross-section

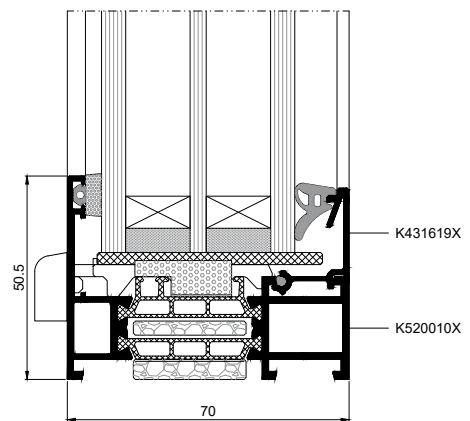

Window with renovation frame  
- cross-section

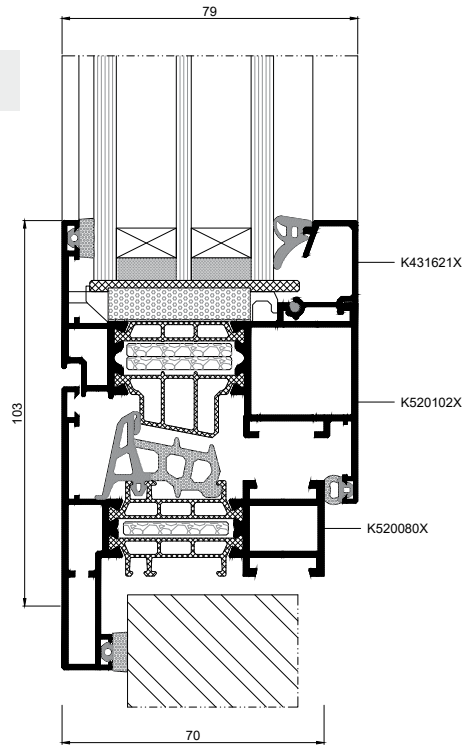

MB-79N SI openable and fixed window -  
cross-section

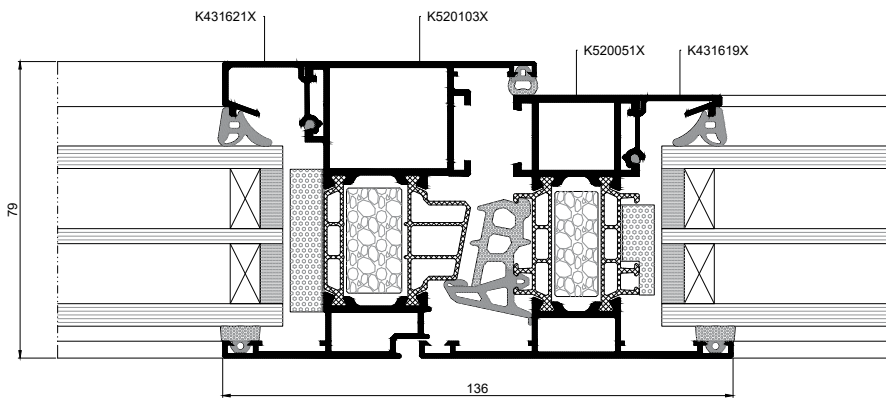

MB-79N SI openable, 2-leaf window -  
cross-section

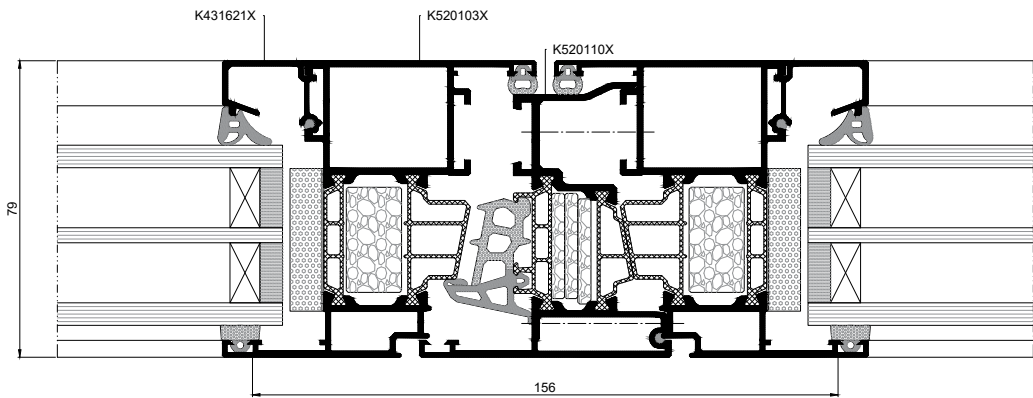

Angular connection - cross-section

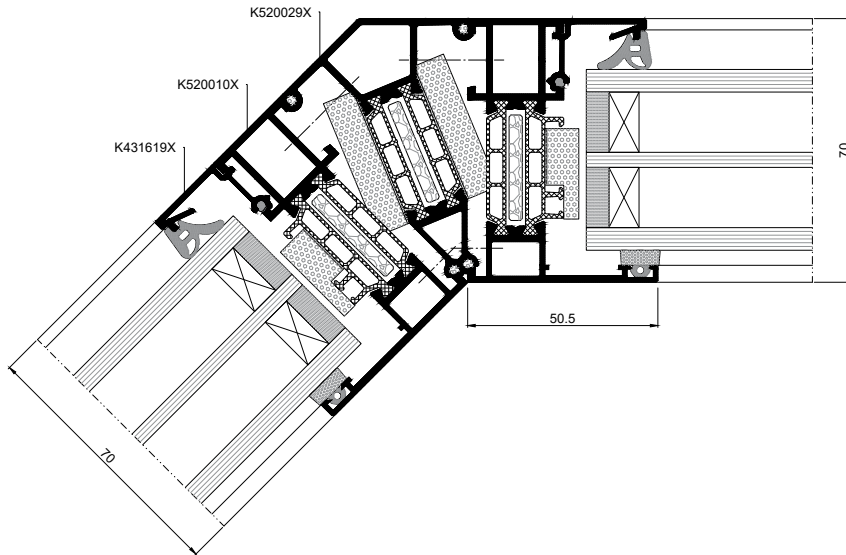

Angular connection - cross-section

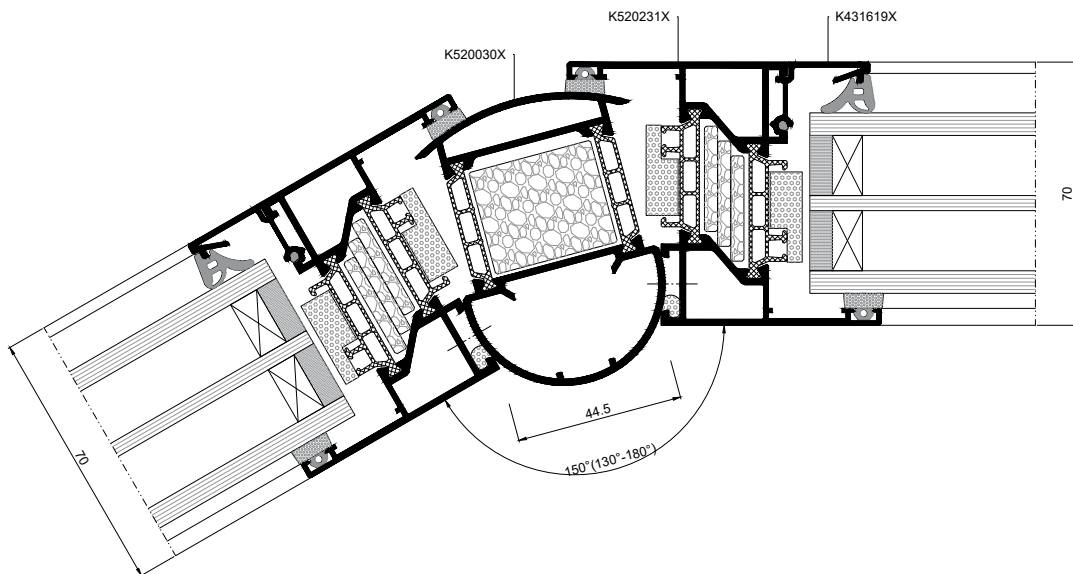

MB-79N SI balcony door  
with low treshold - cross section

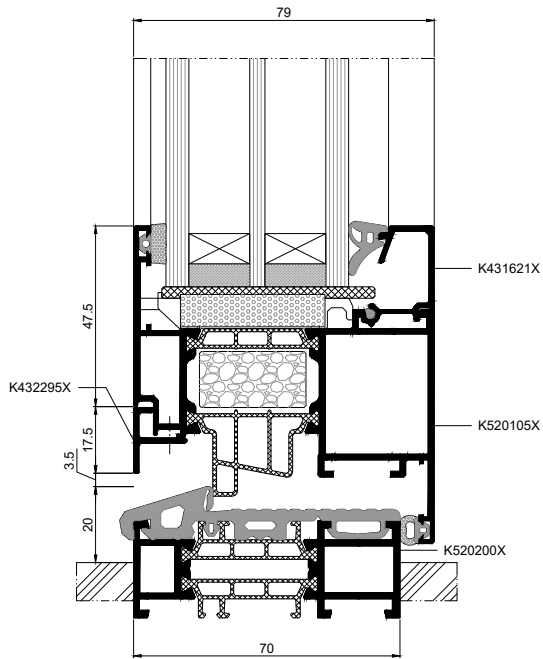

MB-79N SI balcony door  
with low treshold - cross section

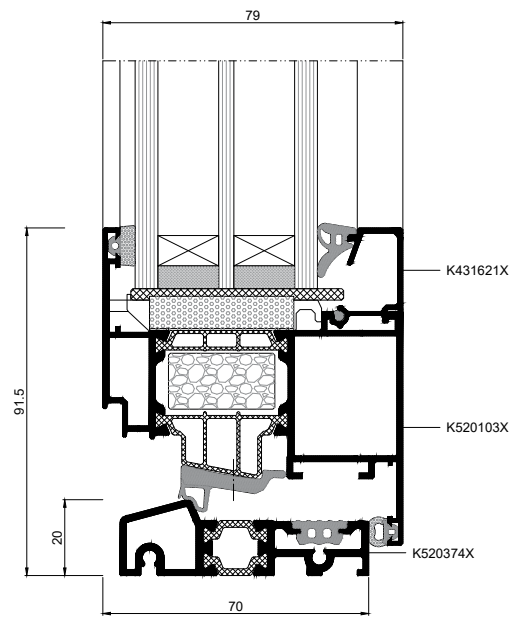

MB-79N SI window in MB-SR50N HI+ curtain wall  
- cross section

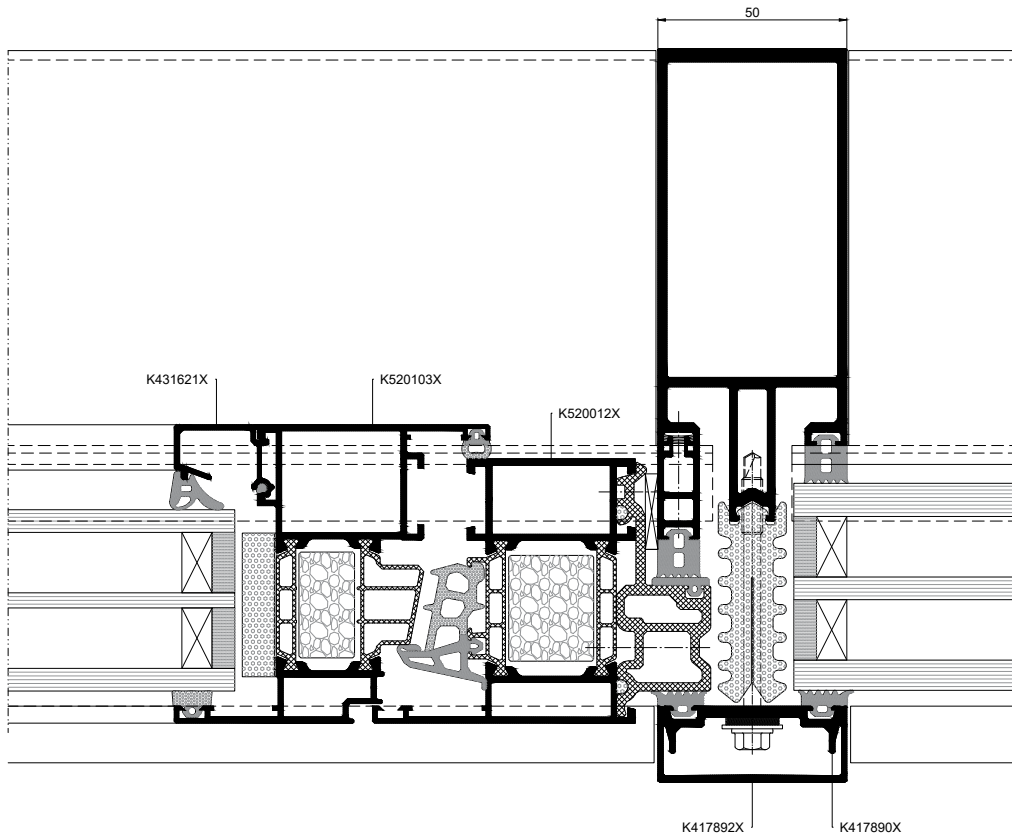



MB-79N E, ST door, cross section

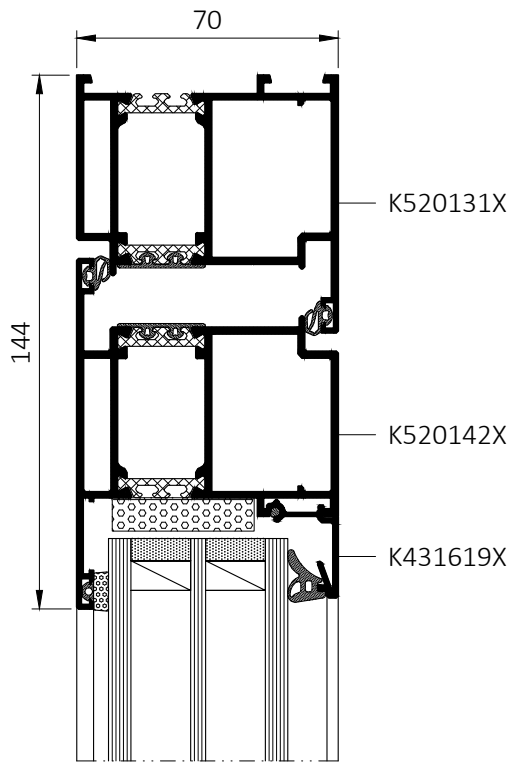

MB-79N SI+ door, cross section

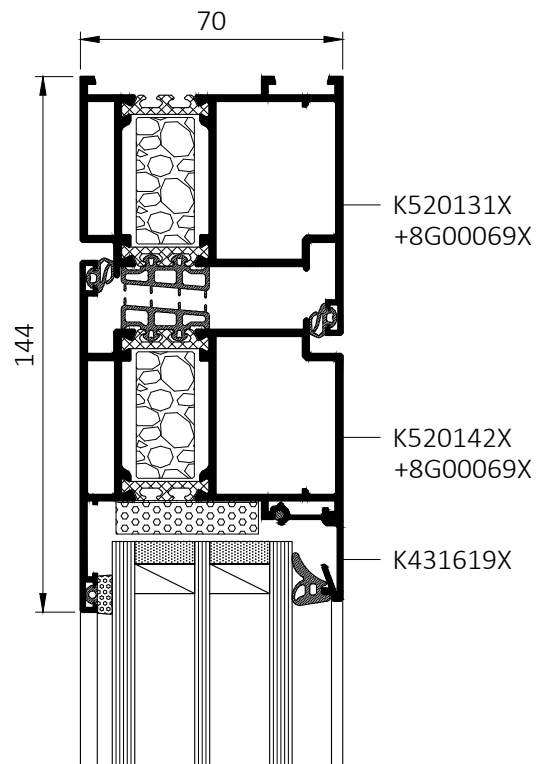

MB-79N SI+ double door, cross section

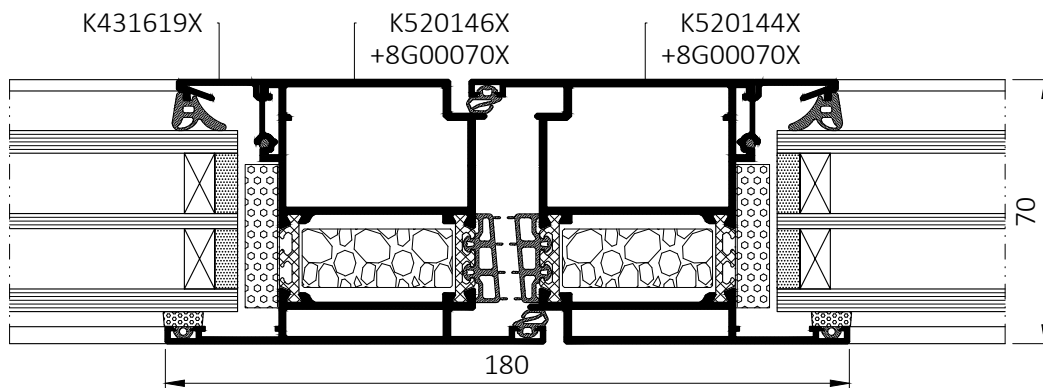

MB-79N SI+ door, cross section

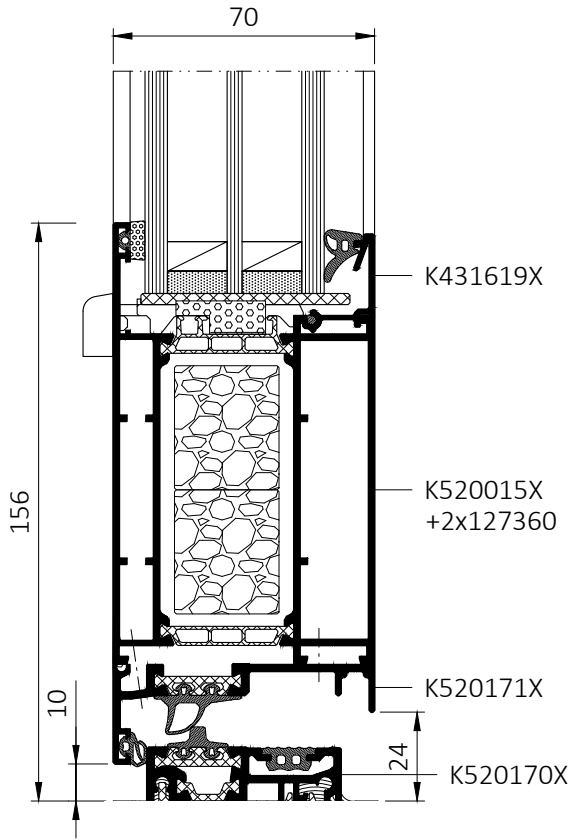

MB-79N SI+ door, cross section

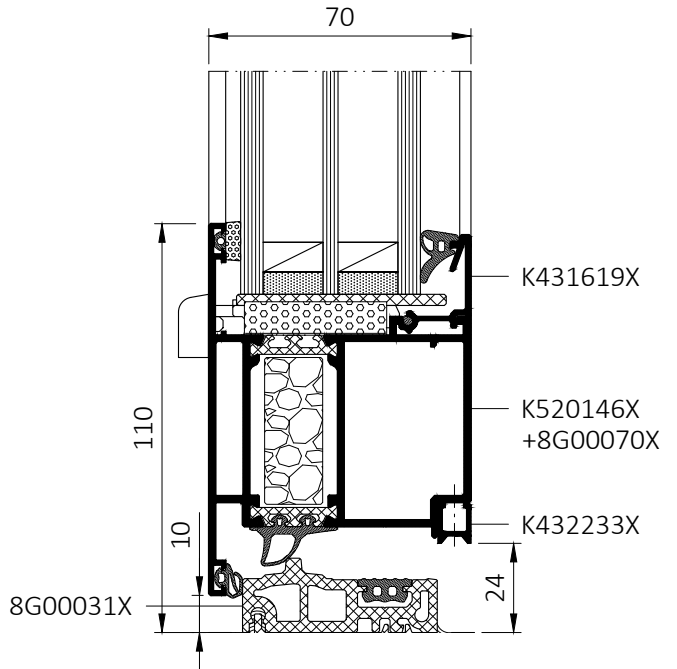

MB-79N SI+ door, cross section

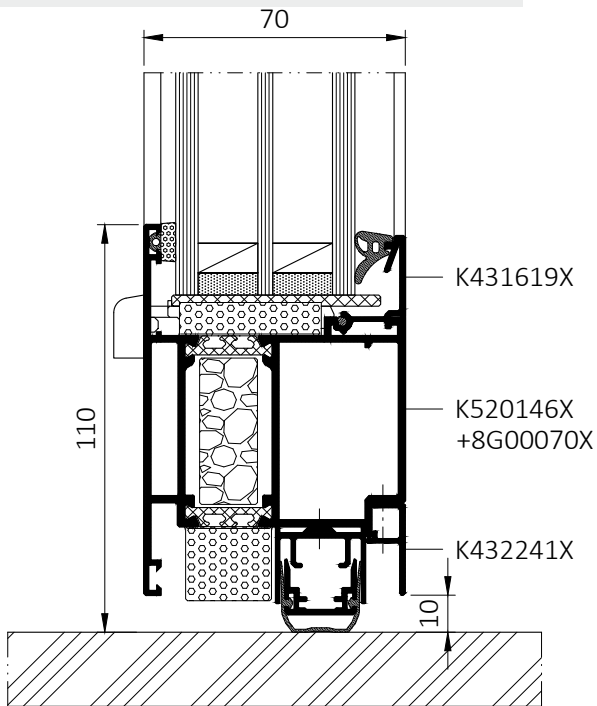

MB-79N SI+ door, cross section

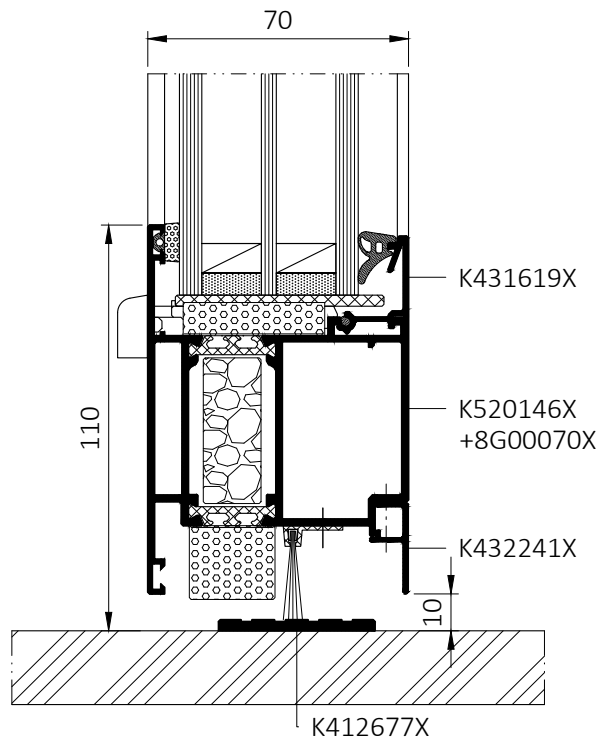

Scale 1:2