

1 Shim Placement - Single Door
DG-IIA SCALE: 1:10

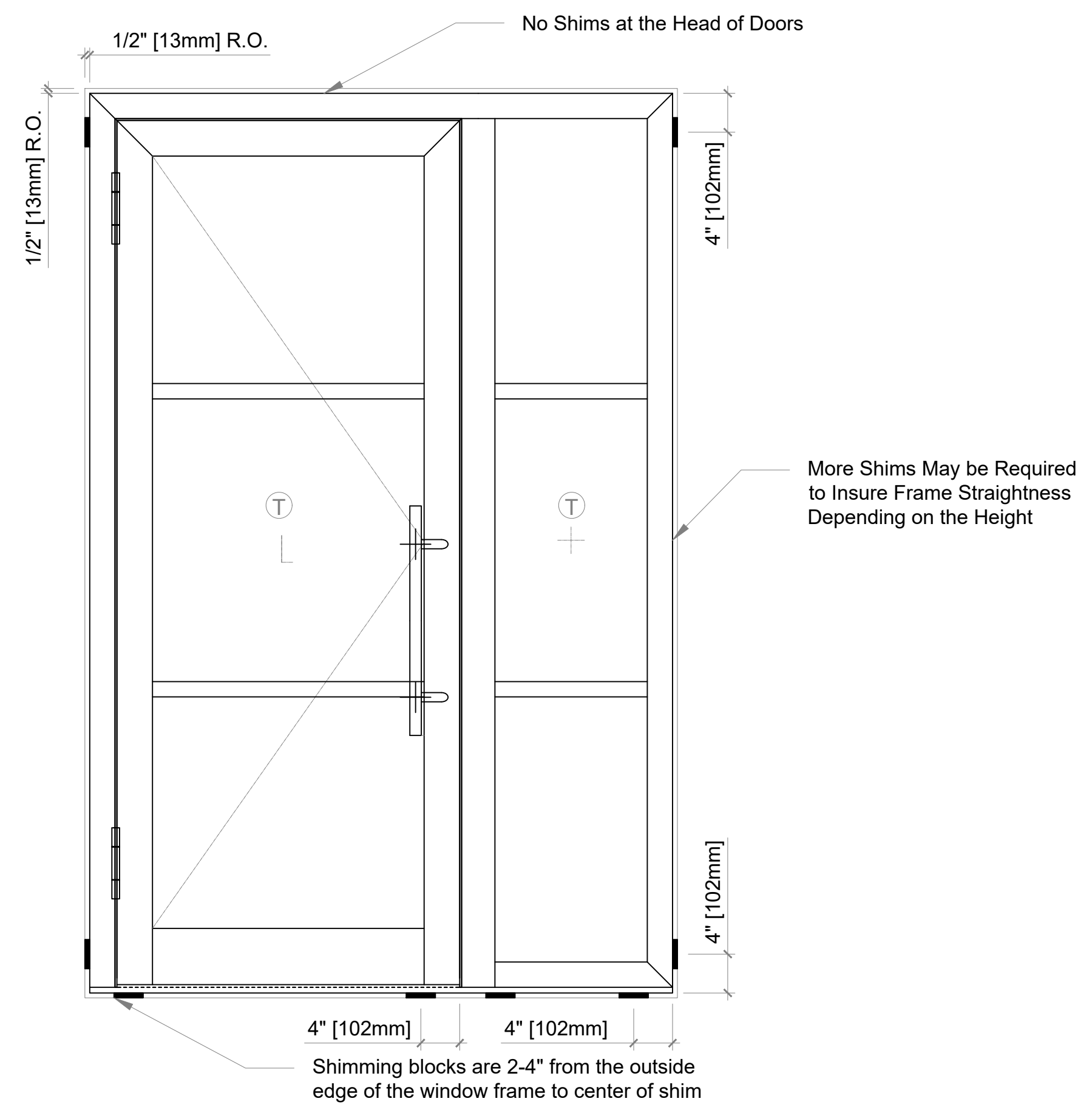

2 Shim Placement - Single Door with Sidelight
DG-IIA SCALE: 1:12

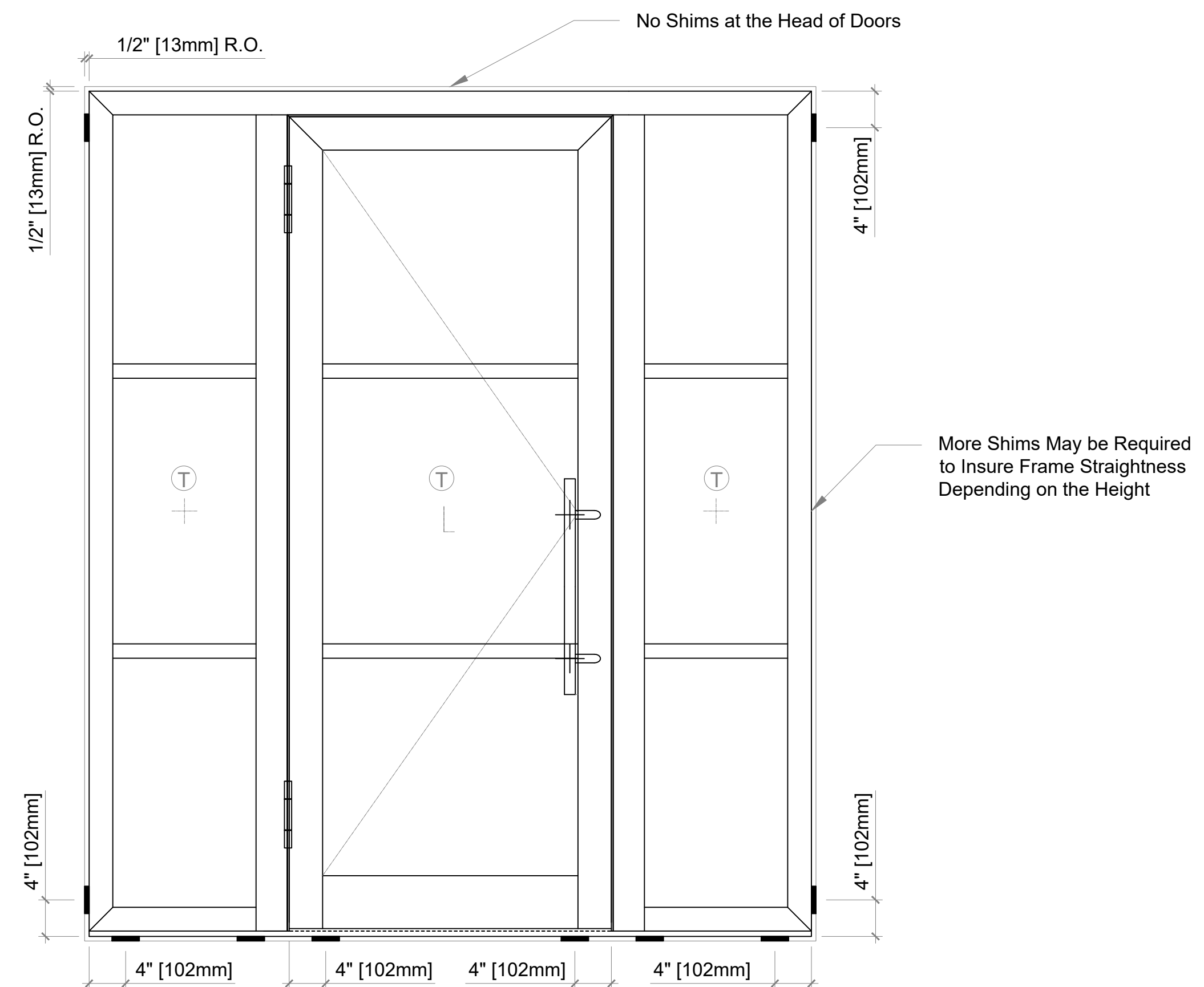

3 Shim Placement - Door with Two Sidelights
DG-IIA SCALE: 1:12

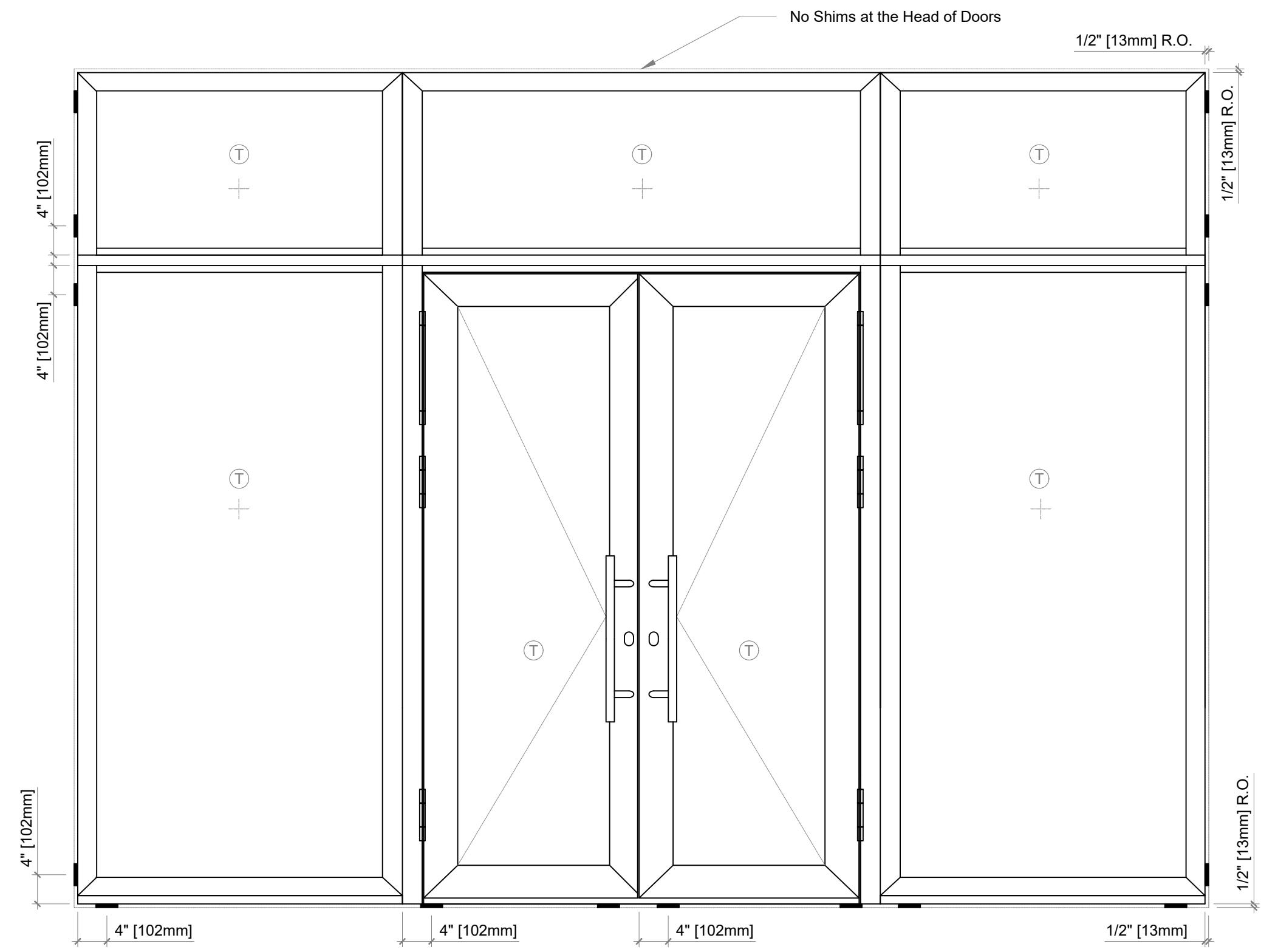

4 Shim Placement - French Door
DG-IIA SCALE: 1:16

Elevation key:

AMBERLINE

Notes:

Shimming blocks are 2-4" from the outside edge of the window frame to the center of the shim.

█ = SHIMMING / PACKING BLOCKS (PLASTIC OR COMPOSITE SHIMS MEANING NO WOOD SHIMS)

No Shims at the Head of Doors

More Shims May be Required to Insure Frame Straightness Depending on the Height

Rules for Shim:
Typical for all 4 sides is 1/2" (12mm)
Max is 3/4" (18mm)
Min is 1/4" (6mm)

IIA

Detail Type : Shimming of the uPVC or Aluminum Door Elements

Drawing Title : Amberline uPVC or Aluminum Shimming & Anchoring Guidelines

Date : 01-13-2023

Drawn By : CN

Scale : Refer to Drawing

Drawing No : DG-01

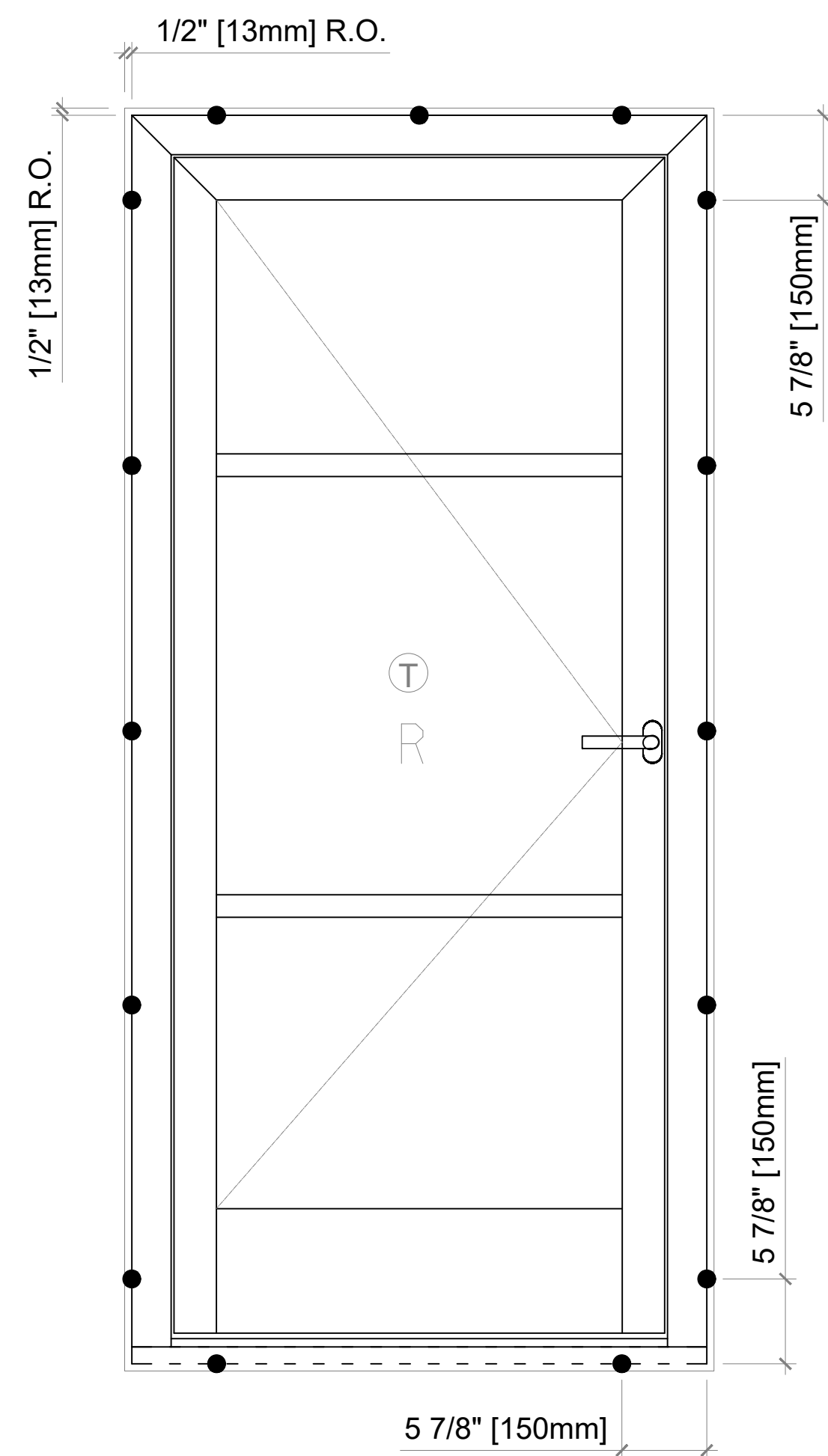

1 Strap Placement - Single Door
 DG-IIA SCALE: 1:10

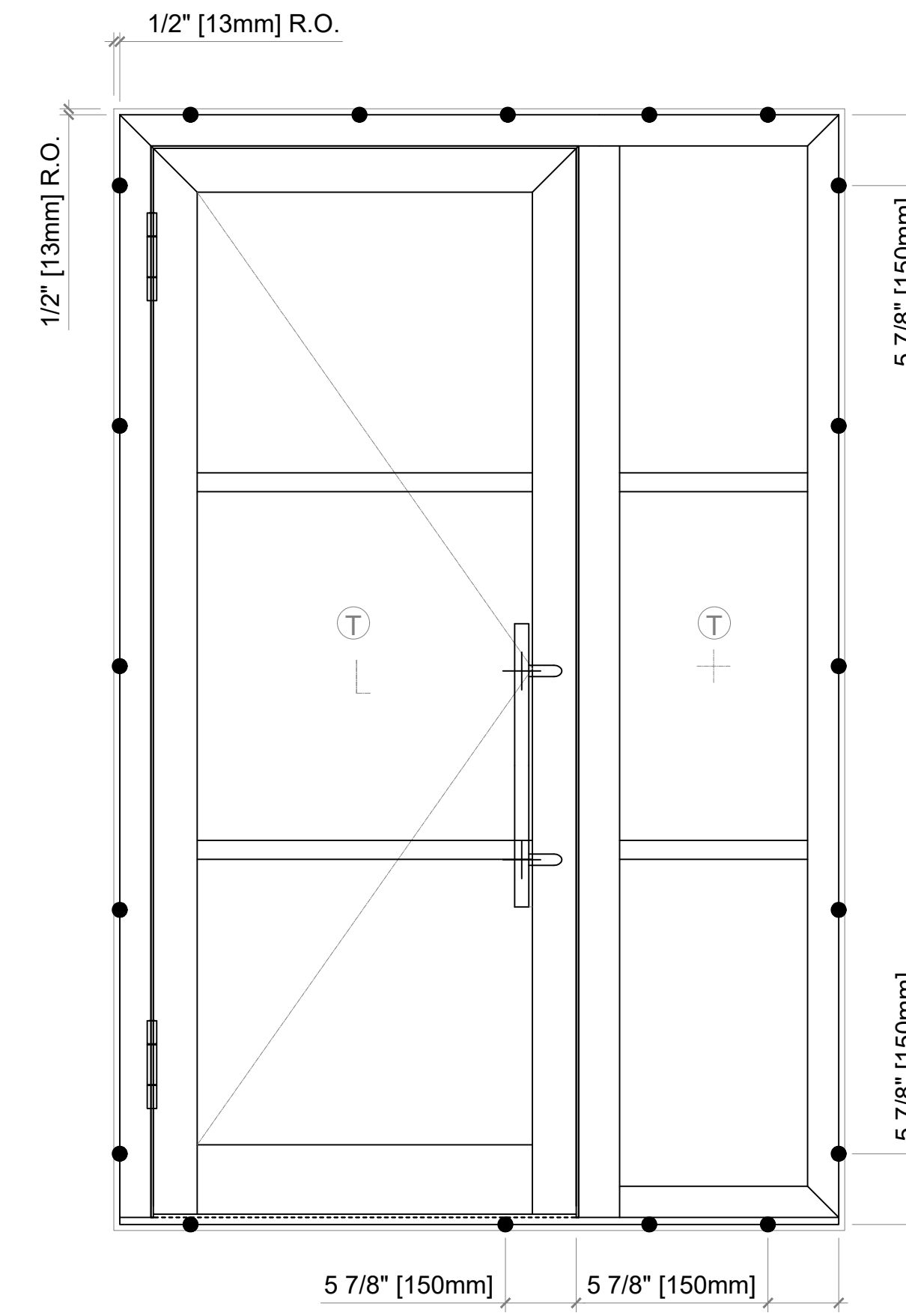

2 Strap Placement - Single Door with Sidelight
 DG-IIA SCALE: 1:12

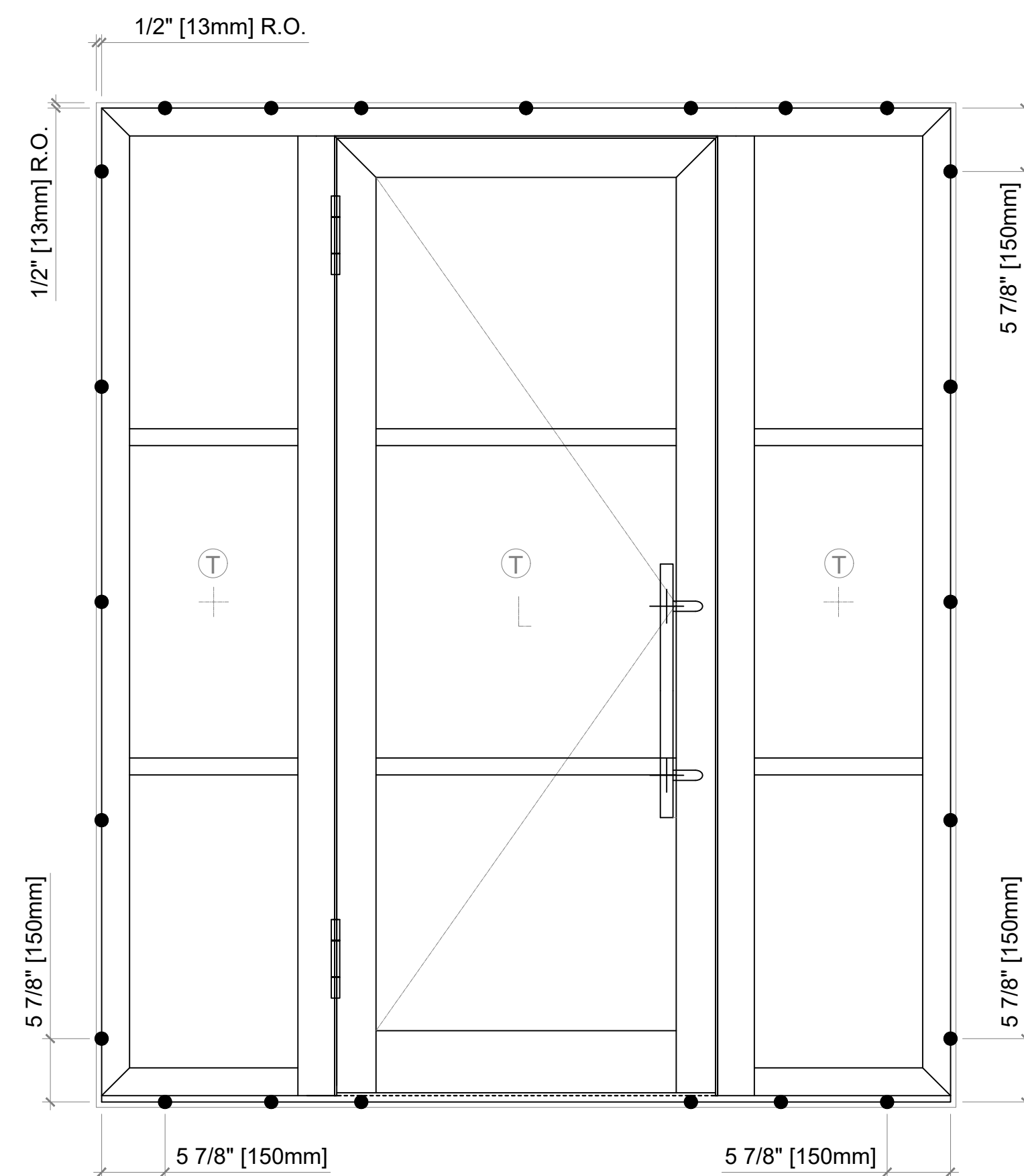

3 Strap Placement - Door with Two Sidelights
 DG-IIA SCALE: 1:12

Field Mullied - Frame to Frame Connection
 Can be Very Weak and Need Extra Support

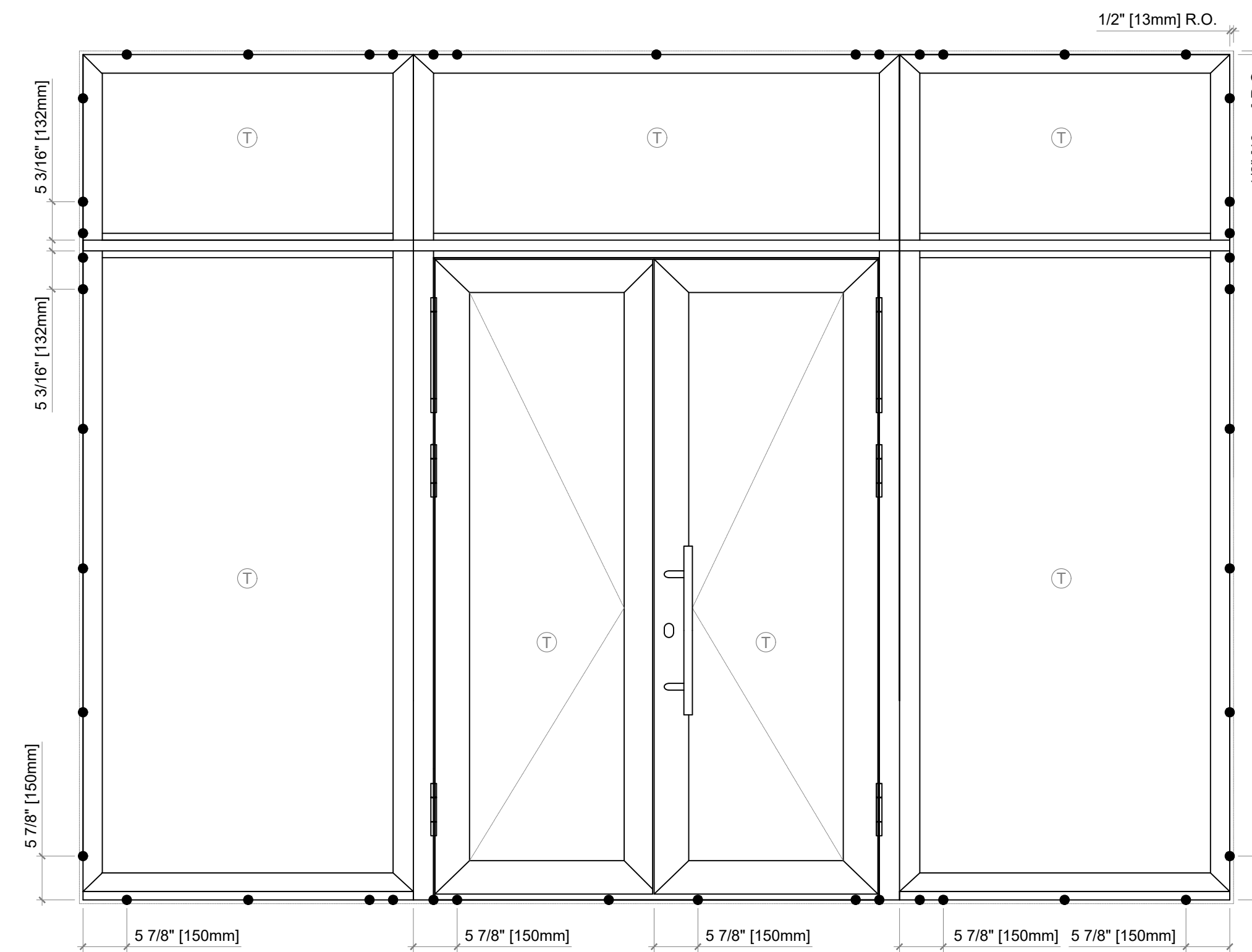

4 Strap Placement - French Door
 DG-IIA SCALE: 1:16

Elevation key:

A M B E R L I N E

Notes:

Typical uPVC frame strap installation at the sill, 70, 76 and 82mm frame profiles (jamb and head are the same with or without the sub sill profile).

● = Strap Placement

Do Not Install Straps Over Shims

IIB

Detail Type : Arrangement of the Straps for Aluminum Door Elements

Drawing Title : Amberline uPVC or Aluminum Shimming & Anchoring Guidelines

Date : 01-13-2023

Drawn By : CN

Scale : Refer to Drawing

Drawing No : DG-01

Elevation key:

1 Step 1: uPVC Strap Installation
DG-IIC SCALE: 1:1 Before the unit is placed in the opening

Rotate the strap flat into the frame channel so that it sits flat against the ALU frame and perpendicular. Typically no screw is needed to fix the strap to the frame.

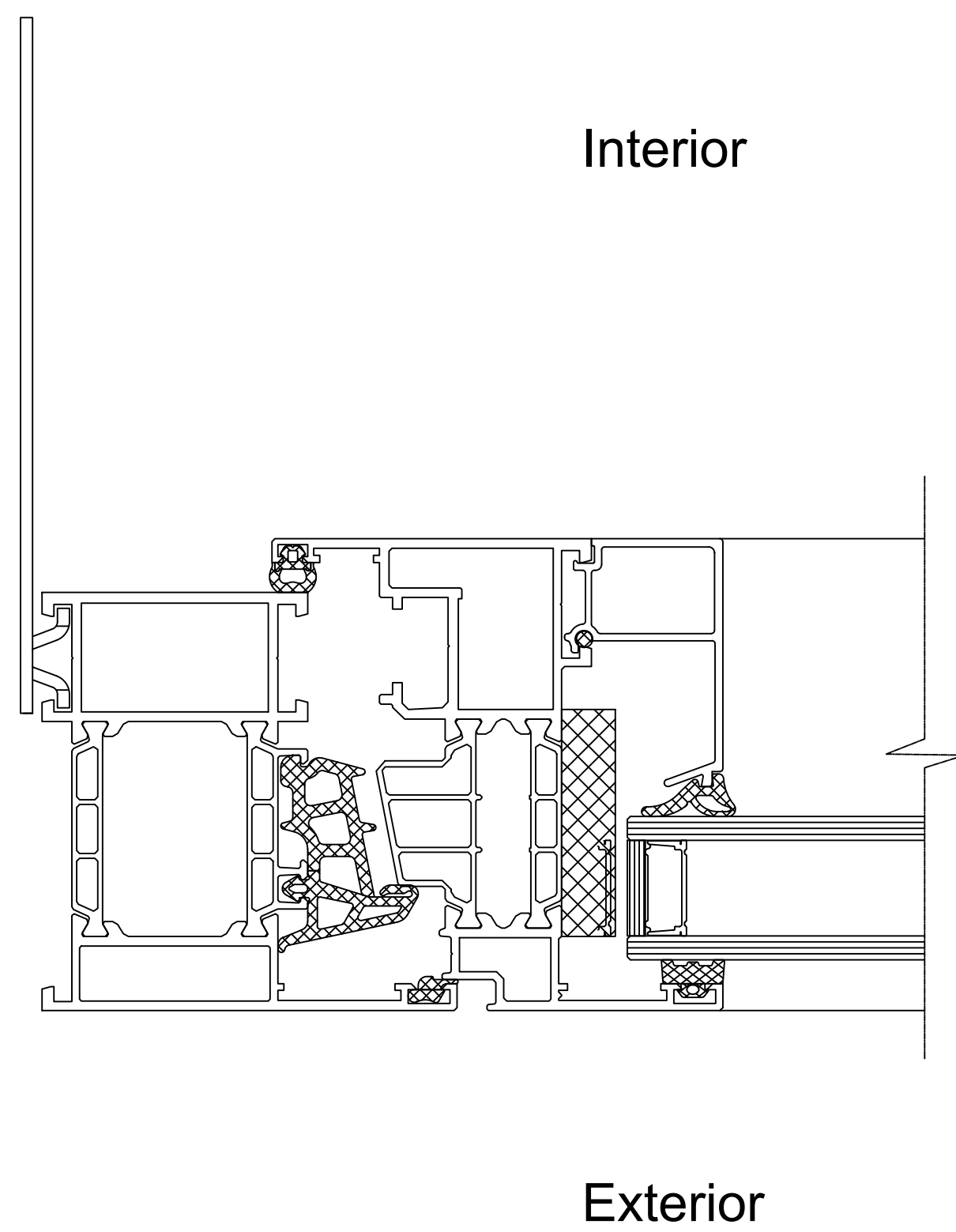

2 Step 2: uPVC Strap Installation
DG-IIC SCALE: 1:1 Before the unit is placed in the opening

Bend all straps inward before placing the window in the opening.

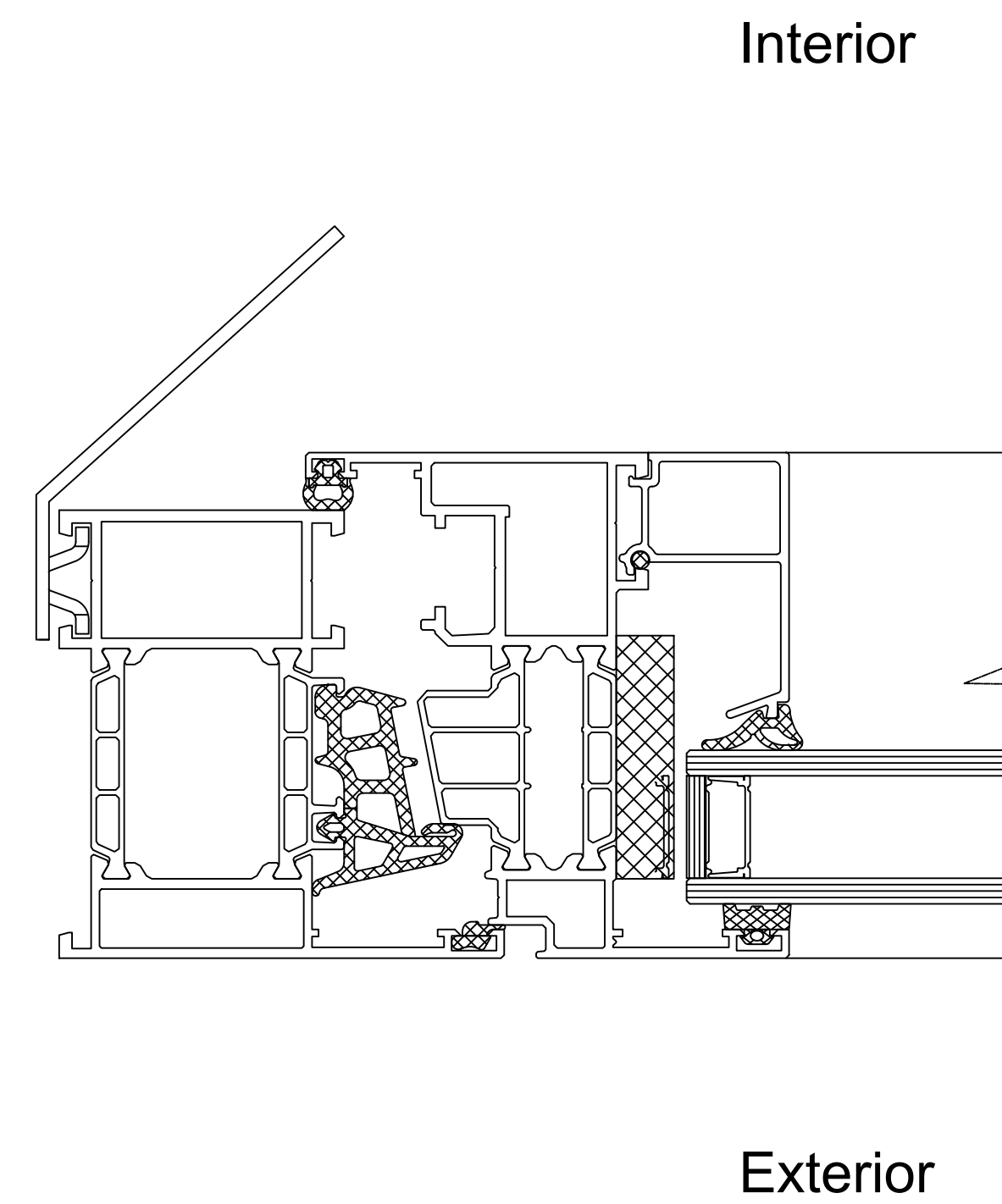

3 Step 3: uPVC Strap Installation
DG-IIC SCALE: 1:1 After the unit is placed in the opening

Once the window is placed in the opening, bend all clips so that they lay flat against the R.O.

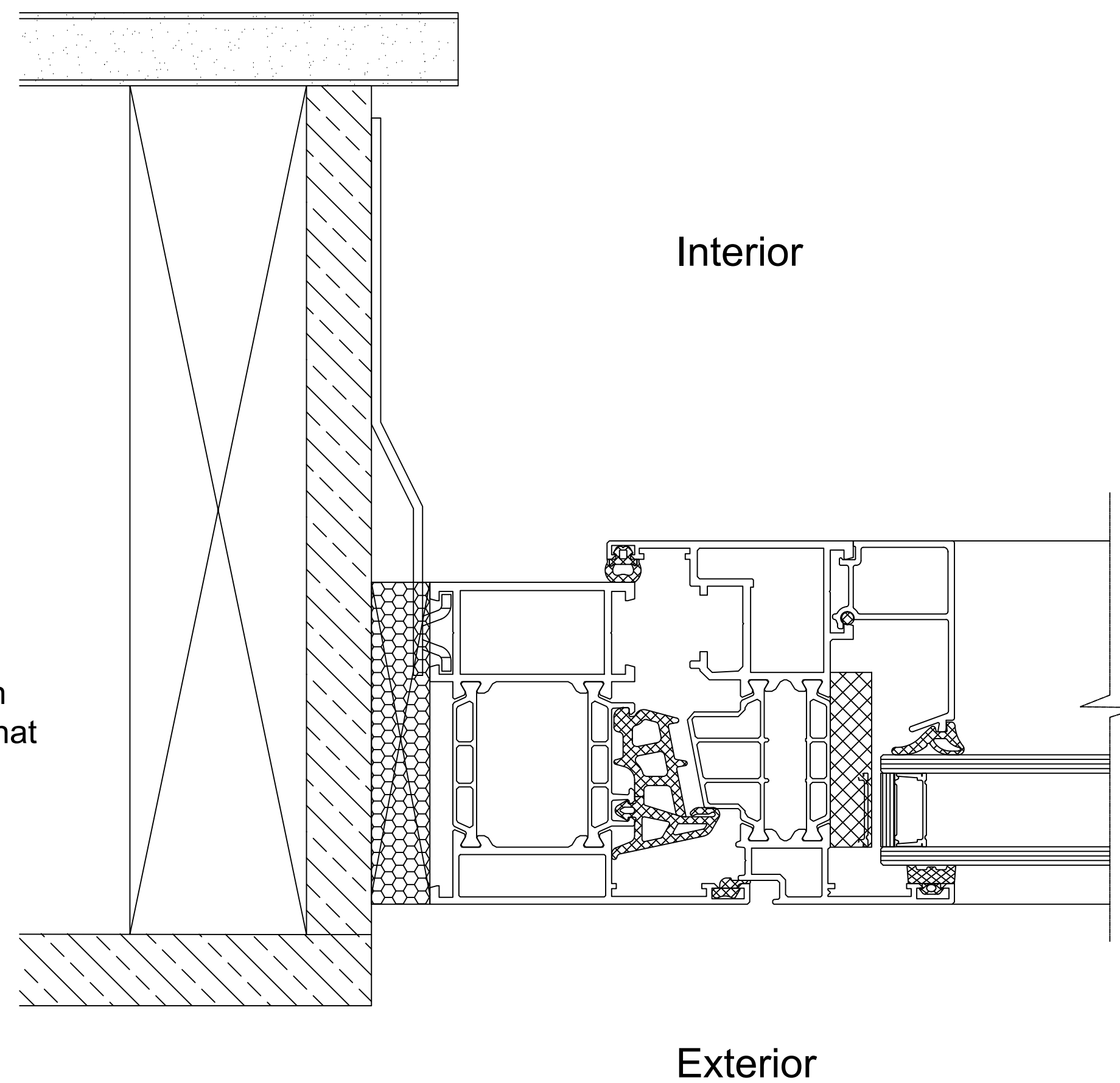

4 Step 4: uPVC Strap Installation
DG-IIC SCALE: 1:1 After the unit is placed in the opening

Fasten 2 screws per clip. When fastening the strap, make sure the frame does not move. (screws spec'd in Notes)

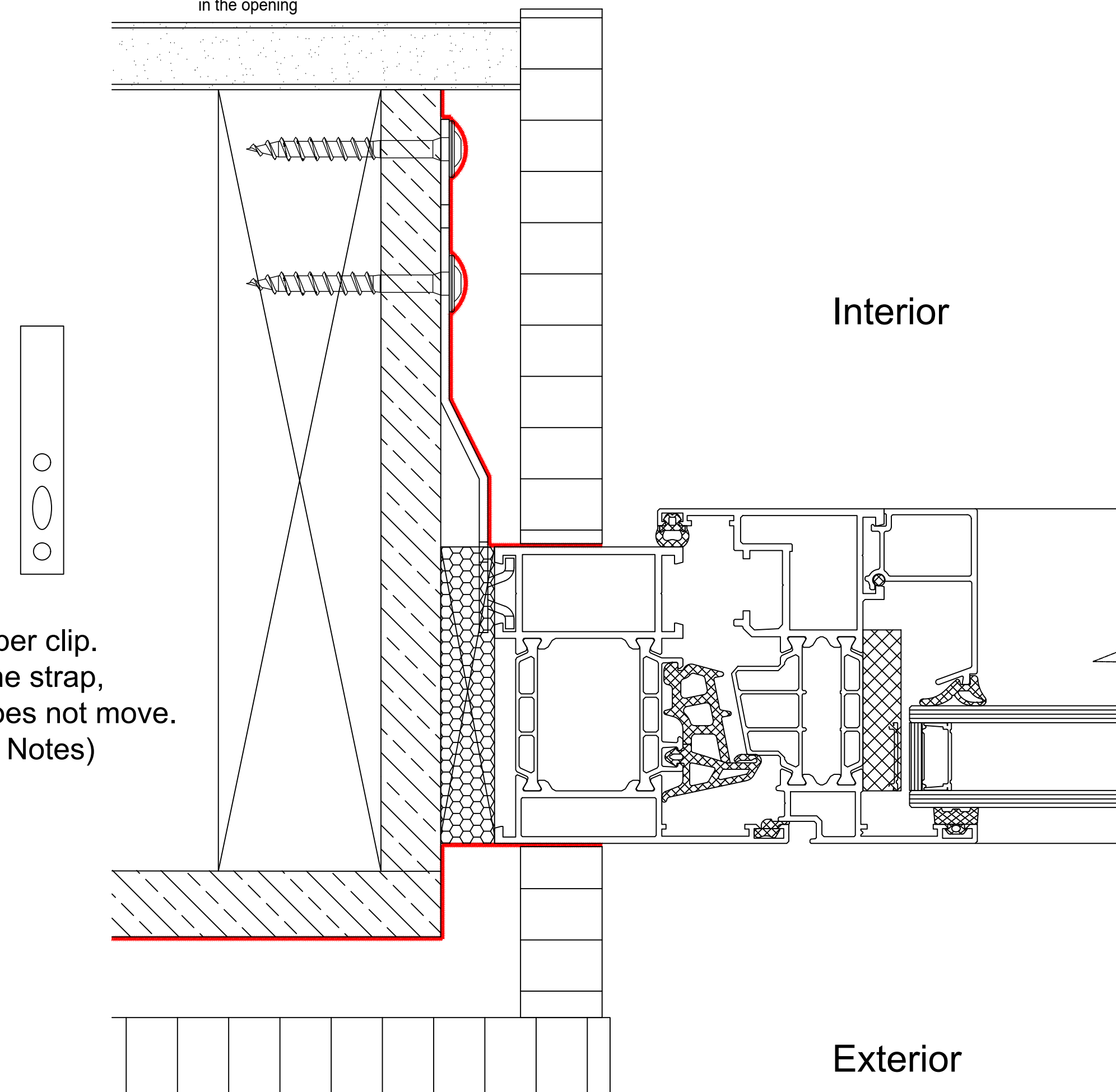

A M B E R L I N E

Notes:

IIC

Detail Type : uPVC or Aluminum Door Strap Installation

Drawing Title : Amberline uPVC or Aluminum Shimming & Anchoring Guidelines

Date : 01-13-2023

Drawn By : CN

Scale : 1:1

Drawing No : DG-0

Shim and Strap Notes:

If any notes are NOT met, your system warranty will be voided.

Shim Notes:

- WHEN THE DOOR IS OVER 5 FEET IN HEIGHT, ADD SHIMS AS NEEDED AT THE JAMBS TO KEEP THE PROFILE STRAIGHT.
- WHEN THE BUILDING IS OVER 3 STORIES, THE SHIMMING COULD CHANGE AND/OR MAY NEED TO ADD MORE STRAPS DEPENDING ON THE WIND-LOAD. ANY ADDITIONAL INFORMATION WILL BE PROVIDED WITH THE PROJECT SPECIFIC SHOP DRAWING.
- NO SHIMS ARE USED AT THE HEAD. SHIMS OR WEDGES CAN BE USED TEMPERATELY FOR INSTALLATION. (SEE DIAGRAM)
- ONLY 2 SHIMS ARE USED AT CORNERS ON THE SILL TO TRANSFER THE UNIT'S DEAD LOAD PATHS. **NO SHIMS ARE TO BE USED IN THE MIDDLE OF THE PROFILE.**
- IF THE SHIM CAVITY IS LARGER THEN $\frac{3}{4}$ ", PAD ROUGH OPENING TO DECREASE THE R.O. GAP TO BELOW $\frac{3}{4}$ ".

Strap Notes:

- ONLY USE THE PROVIDED AMBERLINE STRAPS ON AN AMBERLINE DOOR. SOME STRAPS WILL LOOK SLIGHTLY DIFFERENT BUT THEY ALL WORK THE SAME.
- STRAPS ARE PLACED EVERY 700MM. IF THERE IS AN UNEQUAL DIVISION, ADD ONE MORE EVENLY DISTRIBUTED STRAPS. (SEE DIAGRAM)
- WHEN THE DOOR IS UNDER 1400MM / 55" WIDTH - ONE STRAP PLACED IN THE CENTER OF THE DOOR. (SEE DIAGRAM)
- WHEN THE DOOR IS OVER 1400MM / 55" WIDTH - TWO STRAPS EQUALLY SPACED. (SEE DIAGRAM)
- THERE MUST BE TWO SCREWS PER ANCHORING STRAP, SCREWS NEED TO BE EMBEDDED $1\frac{1}{2}$ " WITH GRK #8 1-1/2" CABINET SCREWS OR EQUIVALENT (GRK #8 $1\frac{1}{2}$ " WOOD SCREWS).
- THE STRAP MUST BE BENT AND SITTING FLAT AGAINST THE BUILDING ROUGH OPENING. (SEE STEPS FOR WINDOW STRAP INSTALLATION ABOVE)

A M B E **R** L I N E

Notes:

IID

Detail Type : uPVC or Aluminum Door
Shimming & Strapping Notes

Drawing Title : Amberline uPVC or Aluminum
Shimming & Anchoring Guidelines

Date : 01-13-2023

Drawn By : CN

Scale : 1:1

Drawing No : DG-0